

Progressive®

Jumbo Potato Cutter

At Progressive our goal is to make your busy life easier with innovative products for your kitchen. This Jumbo Potato Cutter is a fun and easy way to make veggie sticks and french fries.

Leverage Handle

2 Blade Sizes
-25 and 49 Hole

Pusher Plates

Suction Cup Base

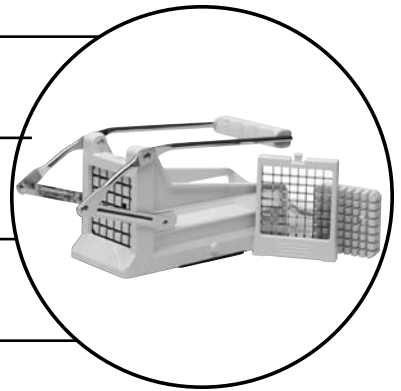

Features / Benefits

- Leverage Handle Cuts Quickly and Easily in One Motion
- Suction Cup Base Provides Stability While Cutting
- 2 Blade Sizes for Thick or Thin Slices

To Use

1. To change blades, raise the handle to slide the pusher plate back.
2. Remove the pusher plate by turning the white knob on the back to the right.
3. Slightly lift the front of the cutter so that the blade can be removed from the bottom of the cutter.
4. To remove the blade, push the button on the top of the blade and carefully slide the blade out of the frame.
5. Slide the desired blade into place, ensuring that the sharp edges on the blades face the inside of the frame.
6. Align the corresponding pusher grid on the stainless steel plate and turn the white knob to the left to lock into place.
7. Secure the cutter to the counter by turning the silver lever to the left, activating the suction cup base.
8. Release the suction by turning the lever to the right.

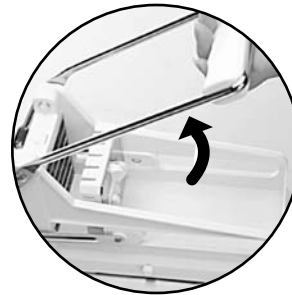

1

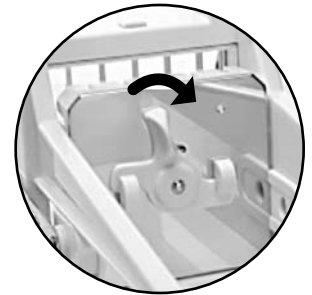

2



3



4



5

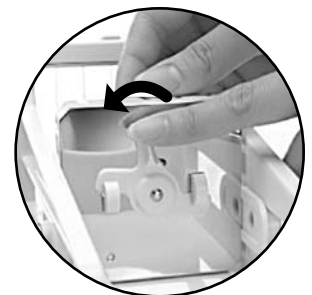

6

Cleaning

- Blades and pusher grid may be placed in dishwasher, however handwashing is recommended for best results.
- Frame of cutter should be handwashed.

Caution!

- Handle with care, blades are very sharp!
- Do not allow children to use this product.



Do Not Touch Blades



7



8